



DIY PROJECT INSTRUCTIONS

www.seedpodstudio.co.za

'F' is for FOX

by Jacqui van Zyl (2013)

Staying up to date and trying something new; a fairly monochromatic graphic print for a really funky fantastic fox!

Firstly, you need to trace the fox pattern and cloud design onto your circular wooden shape, once this is in place you can draw your chevron design background on. As this painted background takes quite a lot of time to do you can avoid the fox and cloud area's which will be covered with clay. We used white, grey, black and a few accents of pineapple for pop! Once that is dry, spray the board with a clear wood sealer for protection. -----> 1.

Now cut your fox paper pattern out into individual pieces and start working your polymer clay in your hand until it is soft and free of air bubbles. Roll it out on a piece of wax paper (or a cutting matt works really well!) using a rolling pin or if you have an old pasta machine that has been dormant for while you can use that. TIP: keep pasta machine on it's thickest setting so your clay doesn't come out too thin. Now start to stamp and press your designs/textures into the clay. 2 & 3.

Now that you have stamped some pieces of clay in textures, cut around the pattern pieces, to the shape required. 4 & 5 & 6.

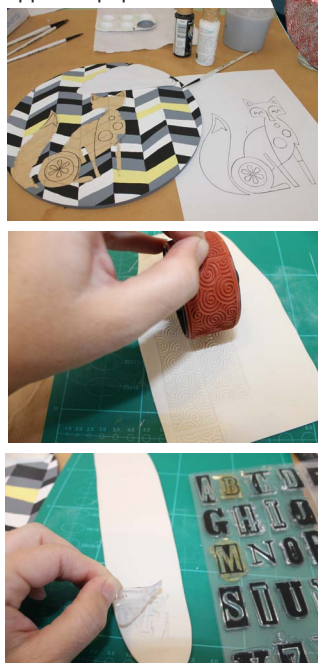

MATERIALS

- Round wooden blank
- FOX Design
- White polymer clay
- Clay cutter and craft knife
- Pearlex powders (we used):
 - Black
 - Russett
 - Silver
- Acrylic paints (we used):
 - Black / White
 - Grey / Pineapple
- Assorted rubber stamps & rollographs
- Paint brushes / Scissors
- / Wood glue

Once you are happy with the the individual pieces and overall design, you can start to add colour to your clay pieces. This can be done using a combination of acrylic paints with Pearlex Powders. Using your finger, simply dab into the powder (shake off any excess as you don't want it going into your textures) and rub gently over your textured surface. You can use multiple colours on one piece and shade different areas, fading colours into each other. It is really simple and the effects are amazing!

When you are colouring a whole piece it's often better to paint the sides of the clay piece so you don't get the white clay colour sticking out. You can also use a brush to paint on some of the acrylic colours you want to include.

Now you can place your clay pieces onto a baking tray and bake your pieces in the oven according to whichever polymer clay you used instructions.

Once they are out of the oven and have cooled down, you can stick all your pieces to the circular background piece using wood glue – not too much so that it starts oozing out the sides, but just enough to stick. We also just use wood glue to stick the clay pieces on top of each other, the triangular piece on the tail and the circles for the chest etc.

Now – using a black felt tip pen - you can add some detail onto the fox – drawing in his eyelids and some detail onto his chest area.

The result is something fun and fresh - hope you enjoyed this project!

